



**Interreg**



Co-funded by  
the European Union

**Estonia – Latvia**

# **EE-LV00143 RIVERWAYS II**

---

**Alise Lūse  
Project Leader**



KURZEMES  
PLĀNOŠANAS  
REĢIONS

**PMM meeting 27.02.25**

## **Today's topics**

- Status with 1st partner reports & modifications**
- Investments – pier sketches so far & best practices & tips from accessibility expert**
- Inspections (desk-search & at sites) & questionnaire**
- Status with riverways.eu website & FB pages & access rights**
- Visit to Finland**
- Training of water tourism operators**
- Large-scale & local events spring-autumn 2025**

## - Status with 1st partner reports & modifications

- **1st modification:** budget reallocations in RPR staff costs, change of pier site in Kuldīga county & technical discrepancies in A3.5.

**Partner reports, all approved:**

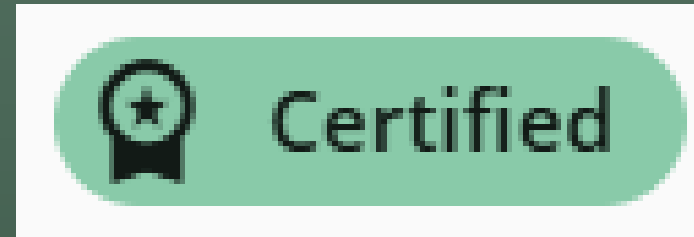

0-cost report: DKN, Liepāja, Kuldīga, Jūrmala, Ķekava, Ādaži, Valmiera, Madona, Valka, Limbaži, GRP, Luunja, Antsla, Setomaa, Voru

Reports with costs: KPR, RPR, VPR, UT, SATT, Otepaa

# - Investments – pier sketches: best practices

## Accessibility guidelines mapeirons.eu

<https://www.daugavpils.lv/pilseta/par-daugavpili/pilsetas-zinas/daugavpili-oficiali-atklata-peldvieta-cilvekiem-ar-ipasam-vajadzibam>

### Boating/fishing site

*\*see points on limits for surface, steepness, gaps and obstacles of landing site, pier and connection bridge under Nature trail and resting area section*

#### Boating/kayaking/canoeing site

- Is it possible to land sideways and lengthways?
- Is there an accessible mooring site for a boat/kayak/canoe on the shore?
- Is there an accessible scaffold for entering the boat/kayak/canoe?

- Is there an accessible toilet nearby? (see section Toilet)
- Is the life ring reachable also from the height of a sitting person?
- Is there information on safety rules, contacts, etc.?

- Is the pier for boat/kayak/canoe at least 6 m long?
- Is the surface intact (no dangerous nails, rotten planks)?
- Is there an accessible scaffold for entering the boat/kayak/canoe?

- Is there an accessible trail to and from the shore? (see section Nature trail and resting area)
- Is it possible to move aiding tools to the shore freely?
- Is the connection bridge accessible for wheelchair users and persons with visual impairment?

#### Fishing site

- Is the fishing site at least 1800 mm long and 1800 mm wide?
- Is there a 50 mm protective border along the fishing pier/platform edges?
- Is there a railing in the height of 30-50 cm along the fishing pier/platform edges?

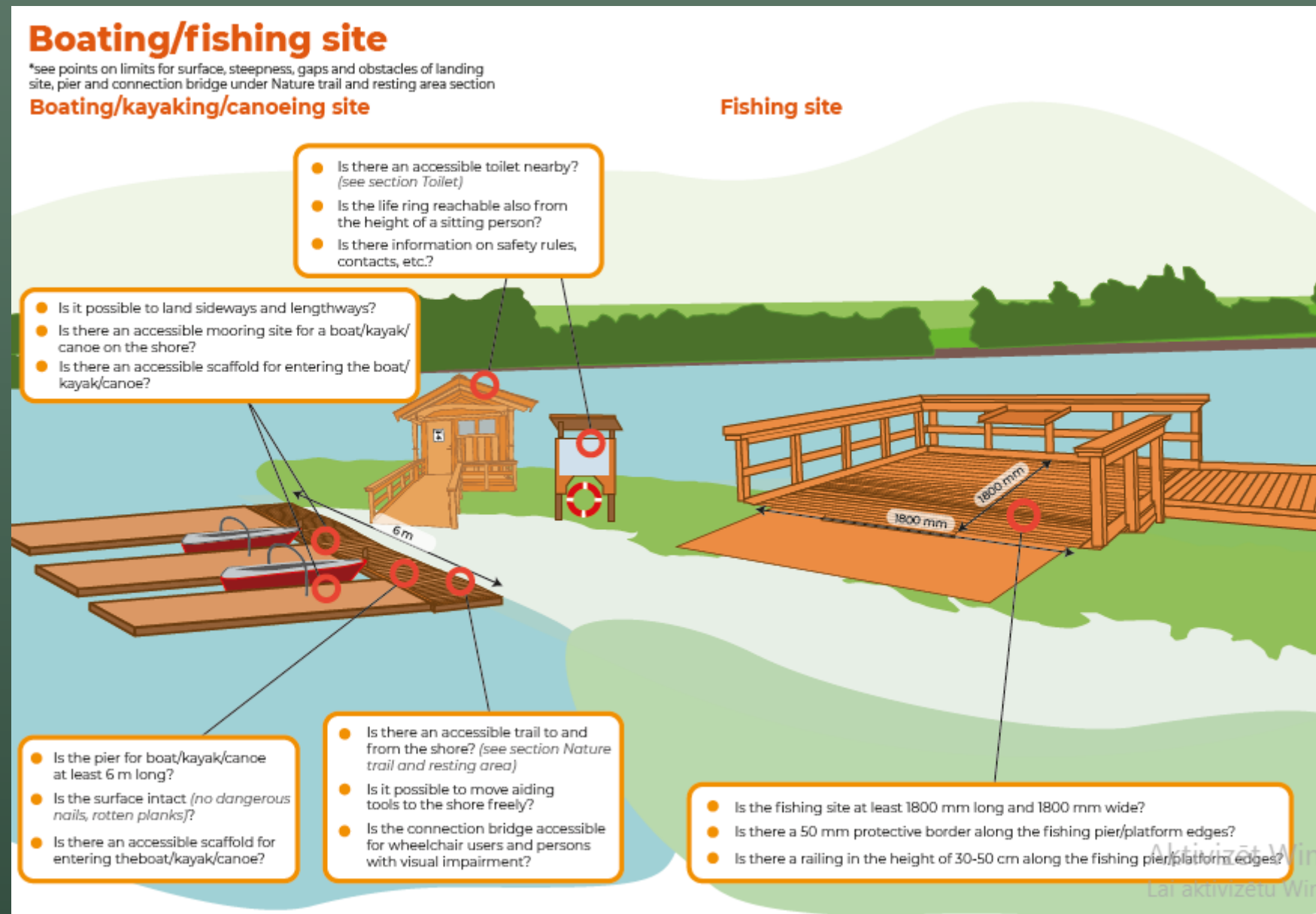



## - Investments – pier sketches: best practices (swimming)





# Testing by the target groups





## - Investments – pier sketches



Valmiera

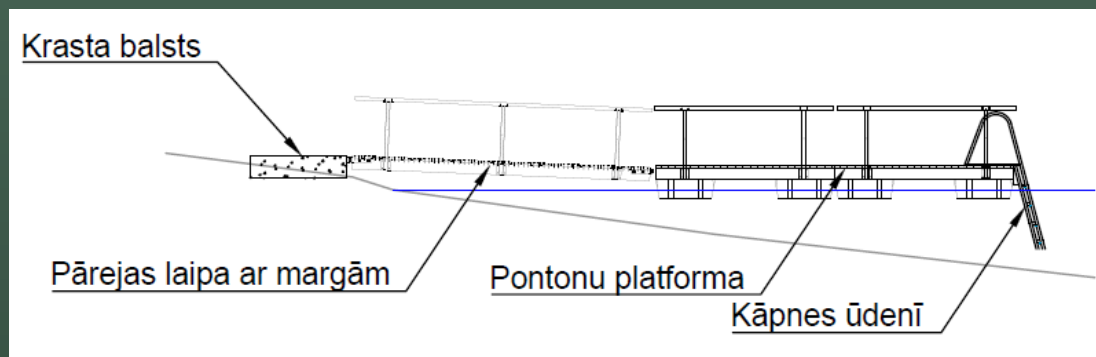

# - Investments – pier sketches

Limbaži

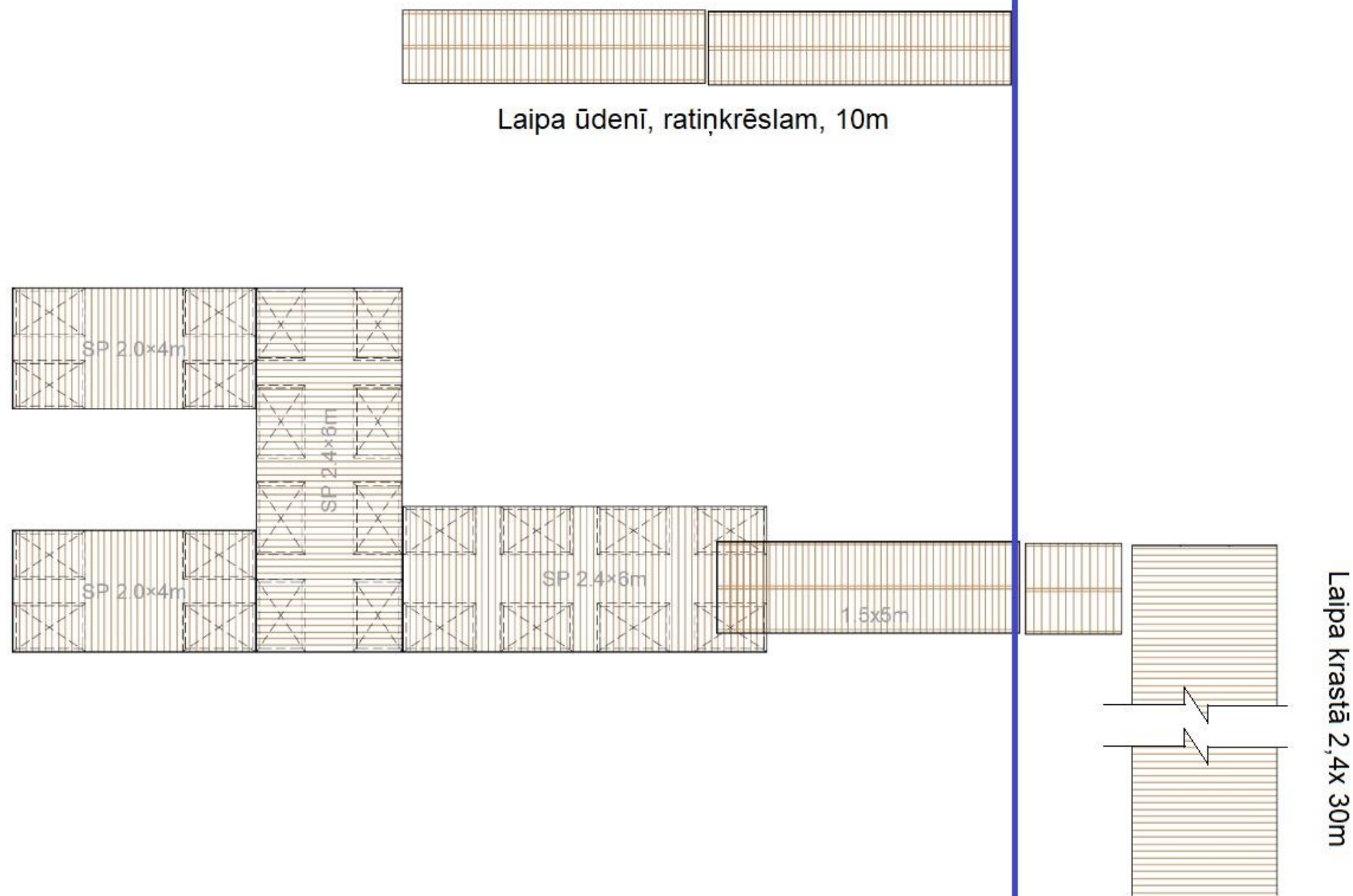



- Inspections (desk-search & at sites) & questionnaire

**1) Desk-search (now): rivers against riverways.eu + lakes: by each municipality**

**- Example**

**2) At sites (spring): accessibility inspections by regional partners (check-lists)**

**To identify 1-2 water tourism «access hubs» for each region**

Questionnaire – LV & EE (15 answers received), in process

## - Inspections (desk-search)

Name of the **lake**

Location (municipalities, region)

Size

Depth

Short description (tourism information, walking paths, infrastructure, other activities)

Parking facilities (location, toilet, resting area etc.)

Type of boats used on the lake or capacity of the lake, SUP? Kayaks? Rafts?

Access points for boating/kayaking (places for route start/end), description of them

Access points for swimming/fishing/diving

Access points for visitors with disabilities

Accommodation

Restaurants & cafes

Recommended routes and short description, what to expect

Operators and offers (boating, water sports)

Any specific restrictions or regulations influencing water tourism on the lake



# Status with riverways.eu website & FB pages & access rights

[www.riverways.eu](http://www.riverways.eu) | [www.upesoga.lv](http://www.upesoga.lv) | [www.seikleveel.ee](http://www.seikleveel.ee)



**Riverways**

544 likes • 546 followers



📷 Edit cover photo

📅 Professional dashboard

✎ Edit

📢 Advertise



## **- Visit to Finland**

**Up to 5 persons per region + hackathon winners' team) (5 days' visit)**

**Shared cost - bus rent, ferry transfer & tickets, catering, accommodation for representatives outside project staff:**

- LP1 KPR 5709 EUR (bus rent)**
- PP2 RPR 7000 EUR (catering)**
- PP3 VPR 4500 EUR (accommodation)**
- PP16 GRP 1000 EUR**

**Total: 18 209 EUR**

**November 6-8 Tampere  
(schedule week 3-9 Nov)**

**<https://apuvaline.expomark.fi/en/>**





# **- Training of water tourism operators**

**Activity 2.3, now – 04.26**

**Key topic - how to serve people with disabilities**

**1 set of events (1 face-to-face/1 online) +1 training session in the nature with clients in each region (one set of event in EE). Approx 20-25 participants**

**Easy to use basic training material (i.a. best practice model) shall be jointly worked out by partners**

**Erasmus+ project MindTour handbook of guidelines for making tourism services more accessible for people with mental impairment**

**UT: 4180 EUR (training & joint development)**

**VPR: 3500 EUR (design & joint development) and 2000 EUR (training of operators in Vidzeme)**

**KPR: 2000 EUR (training of operators in Kurzeme)**

**RPR: 2000 EUR (training of operators in Riga region)**

**UT – to coordinate joint work of partners on service design & development of the training concept & training material**

# - Large-scale & local events spring-autumn 2025 + **PM Meetings**

- LP – hosting 2 PMMs
- VPR – hosting 2 PMMs
- RPR – hosting 1 PMM
- SEDMO – hosting 2 PMMs
- GRP – hosting 2 PMMs
- Setomaa – hosting 1 PMM

One done

One done

01.09.24.-31.12.24.

01.05.27.-31.08.27.

Project periods 1-9 (01.09.24.-31.08.27. 36 months)



A photograph of a person in a wheelchair, seen from behind, sitting on a wooden boardwalk. The boardwalk is made of light-colored wooden planks and has a simple wooden railing on the right side. The person is wearing a light grey hoodie and dark pants. They are looking out over a large body of water, likely a lake or a wide river, under a blue sky with scattered white clouds. The water is calm, reflecting the sky. In the distance, there are some trees and a small structure on the horizon. The overall scene is peaceful and scenic.

# Thank you ☺

[alise.luse@kurzemesregions.lv](mailto:alise.luse@kurzemesregions.lv)

+371 26567874