

Saldus Municipality

WaterMan



THE CIECERE RIVER FLOWS THROUGH THE SALDUS AND IS ITS MAIN DRAINAGE POINT. SALDUS IS FACING BOTH PERIODS OF DROUGHT AND REGULAR FLOODS, IN PARTICULAR IN SALDUS TOWN CENTER THAT IS LOCATED LOWER THAN THE SURROUNDING AREAS AND LACKS WATER RESERVOIRS TO ABSORB WATER FROM HEAVY RAINFALL OR RAPID SNOWMELT. SALDUS IS ARRANGED LIKE A « BOWL ».



To address this issue, the Saldus Municipality has joined the WaterMan project, which aims to provide a solution that combines both the sustainable development of the city and the desires of its residents. In the case of heavy rainfall, the situation in the city center can also be as follows:



Precipitation in City of SALDUS from 2022 - 2024

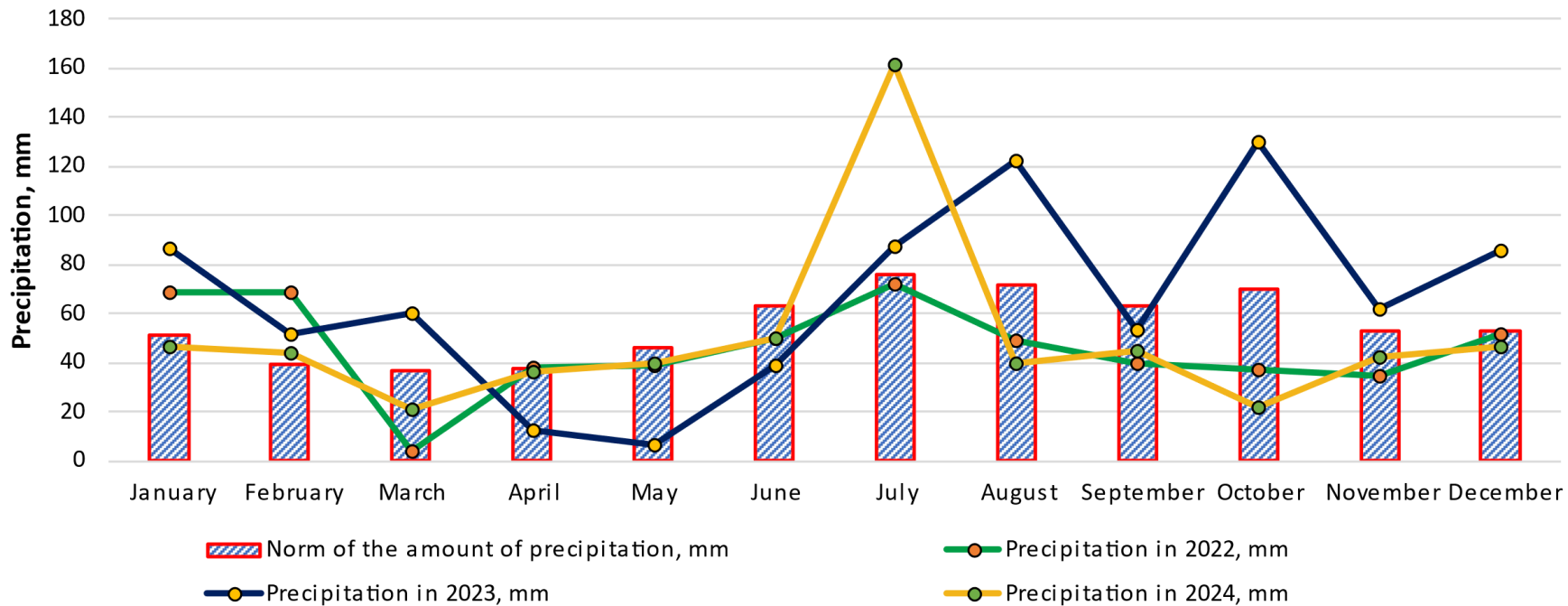

Actions Implemented in the project: a Path to Sustainable Development

- Geological research
- Rainwater analysis
- Development of the project vision
- Preparation of technical documentation
- Communication and public education



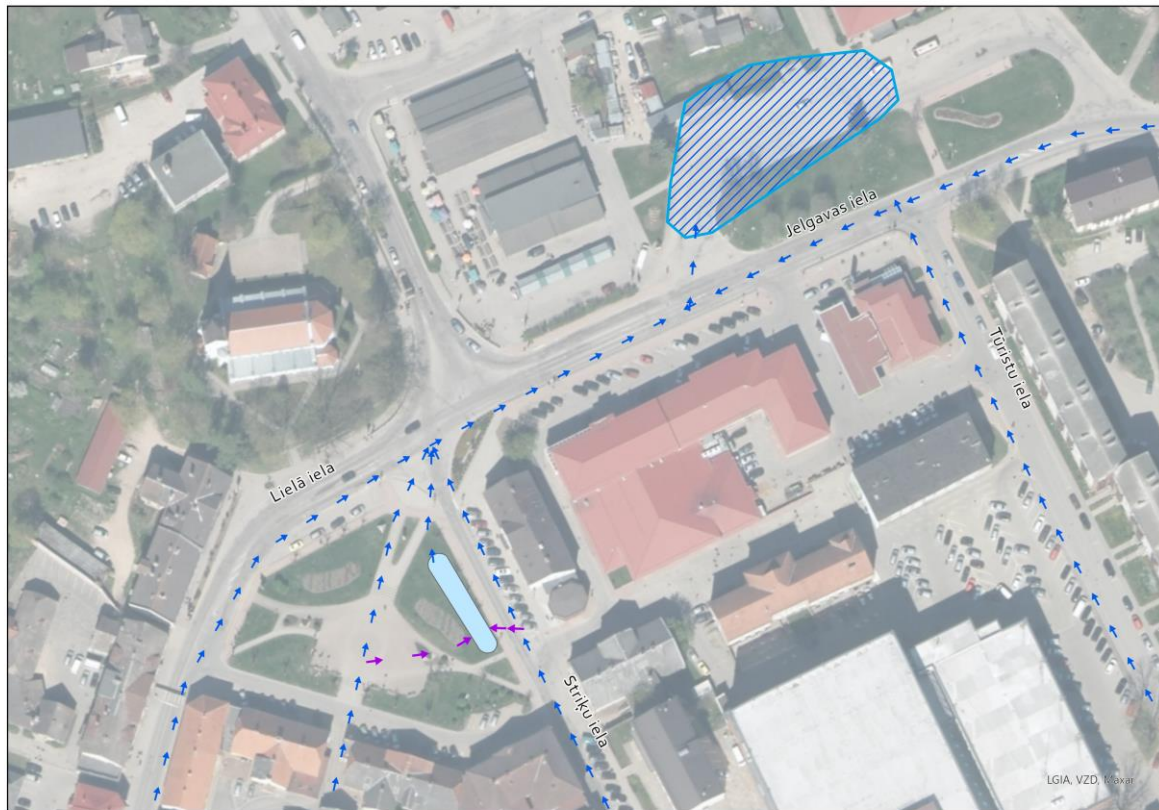

Results of the Analyses of Rainwater in Kalpaka Square

- **Total suspended solids:** 16.2-182 mg/l
- **Conductivity:** 74.9- 130 $\mu\text{S/cm}$
- **Total Microorganism Count (MAFAM):**
 - Total Microorganism Count at 22°C: $2.2-3 \times 10^4$ CFU/1ml
 - Total Microorganism Count at 37°C: 4.2×10^2 CFU/1ml
- **Escherichia coli (CFU/100 ml):** 1.1×1000
- **Intestinal enterococci (CFU/100 ml):** 3.8×1000
- **Petroleum Products:** not detected
- **pH:** 6.6-8.1
- **P total:** < 0.10
- **N total:** 1-2.8
- **COD (Chemical Oxygen Demand):** < 30

Technical Documentation - Multifunktional Use of the Fountain

The educational touch screen will be located here

The underground rainwater reservoir (90+10 m³) will be located here

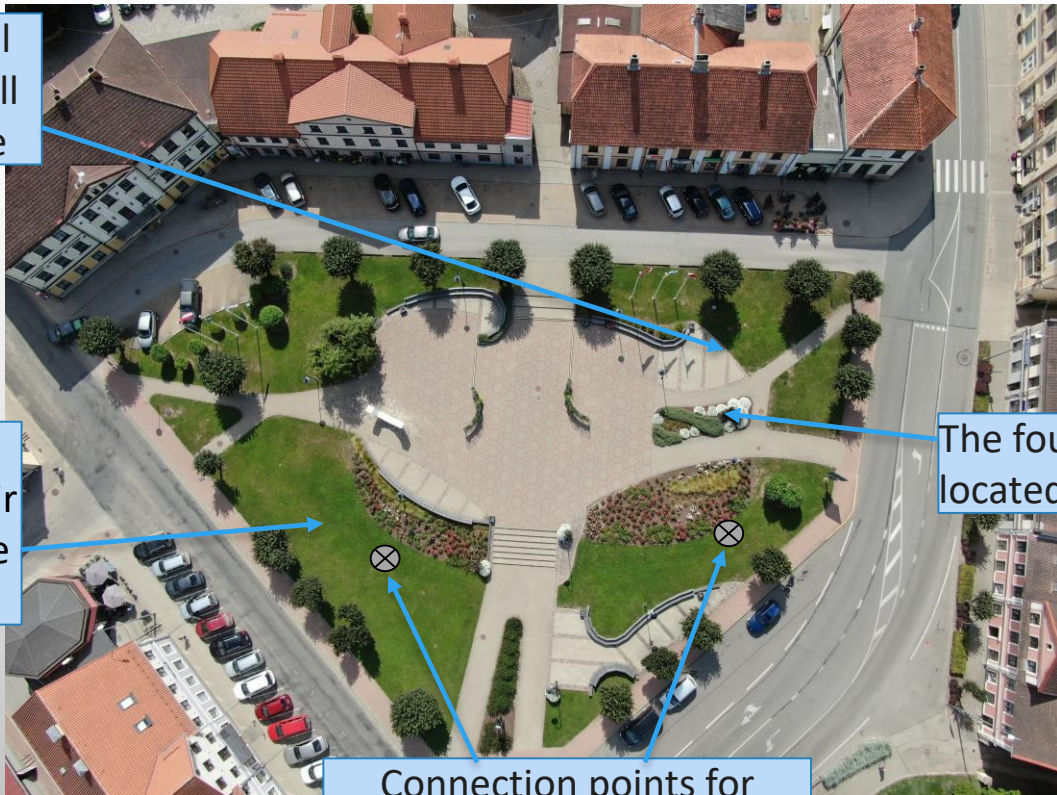

90 m³ rainwater reservoir

Fountain operation

Watering of greenery

The fountain will be located here

Street watering (in spring)

Connection points for greenery watering (located in wells)

Technical Documentation - Multifunkcional Use of the Fountain

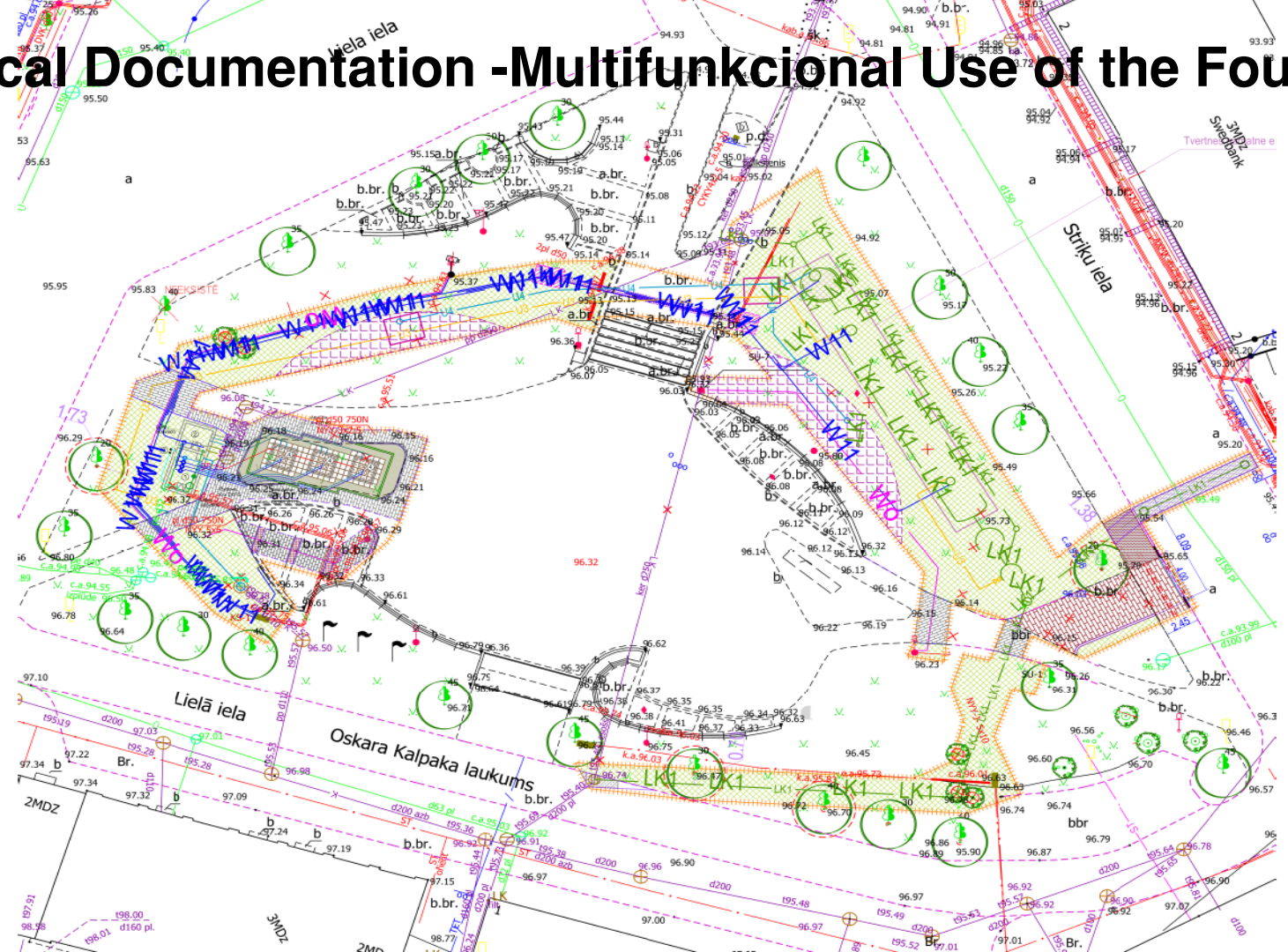

Rainwater circulation scheme

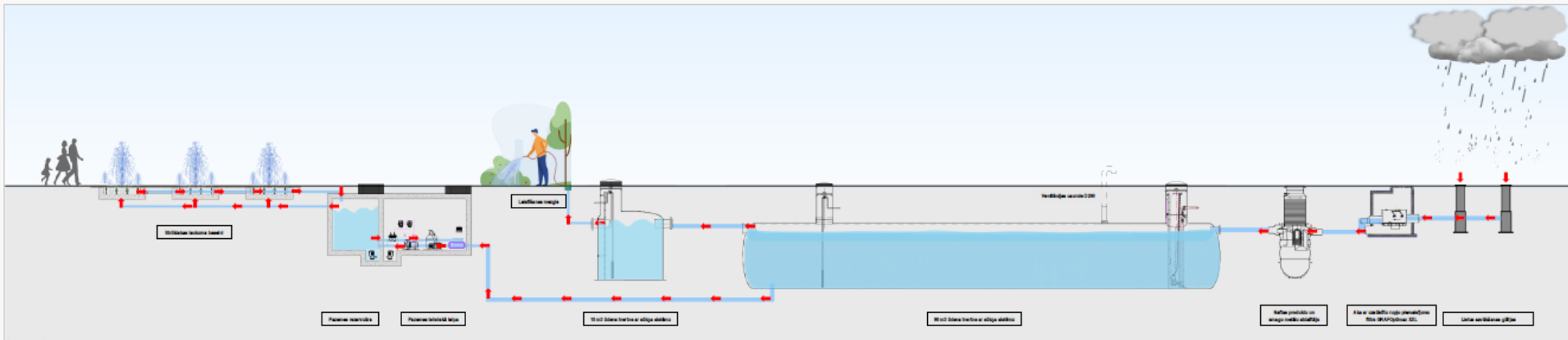

Collected rainwater treatment

Water Quality Requirements:

•pH level: 7.2 to 7.6

•Total water hardness: 8° to 15°
dH (1.4 – 2.3 mmol/L)

•Chloride content: max 250 mg/L

➔ Cleaned from coarse impurities

➔ Separator for Sand and Oil Products

➔ Water Preparation Equipment Unit



2 UV radiation lamps have been installed in the water treatment unit to prevent bacterial contamination

*Done if construction works
are carried out*

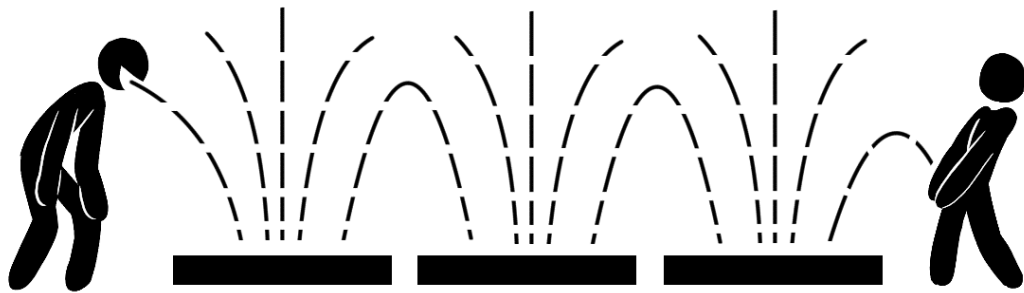

Installed if construction works are carried out

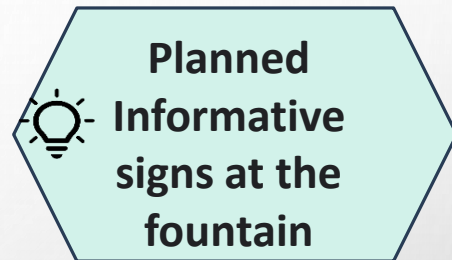
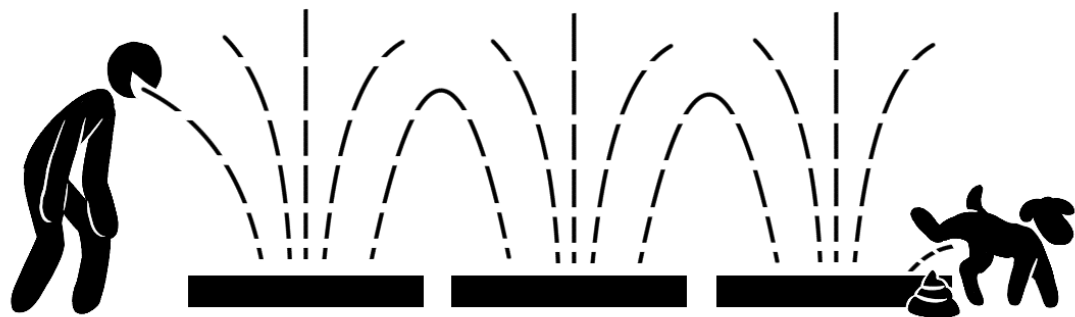

Attention! The water may be contaminated!
DO NOT DRINK!

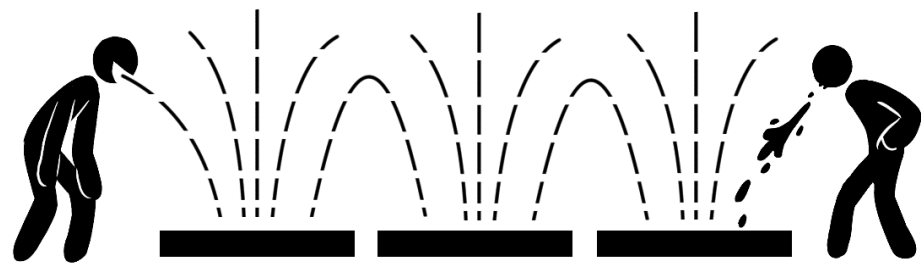

Planned Fountain Monitoring in the Technical Documentation

Installed if construction works are carried out

Damage Signal: Alerts in case of damage or malfunction.

Water Metering Devices: Ultrasonic water meter with data transmission capability. Reflects seasonal water consumption (data updated daily and stored in the database). Water used for irrigation will be recorded separately.

Tank Level Sensors: Informative graphics display level changes over time. Level measurement device.

Data will be displayed on a unified platform with options for transmission to tablets and third-party systems.

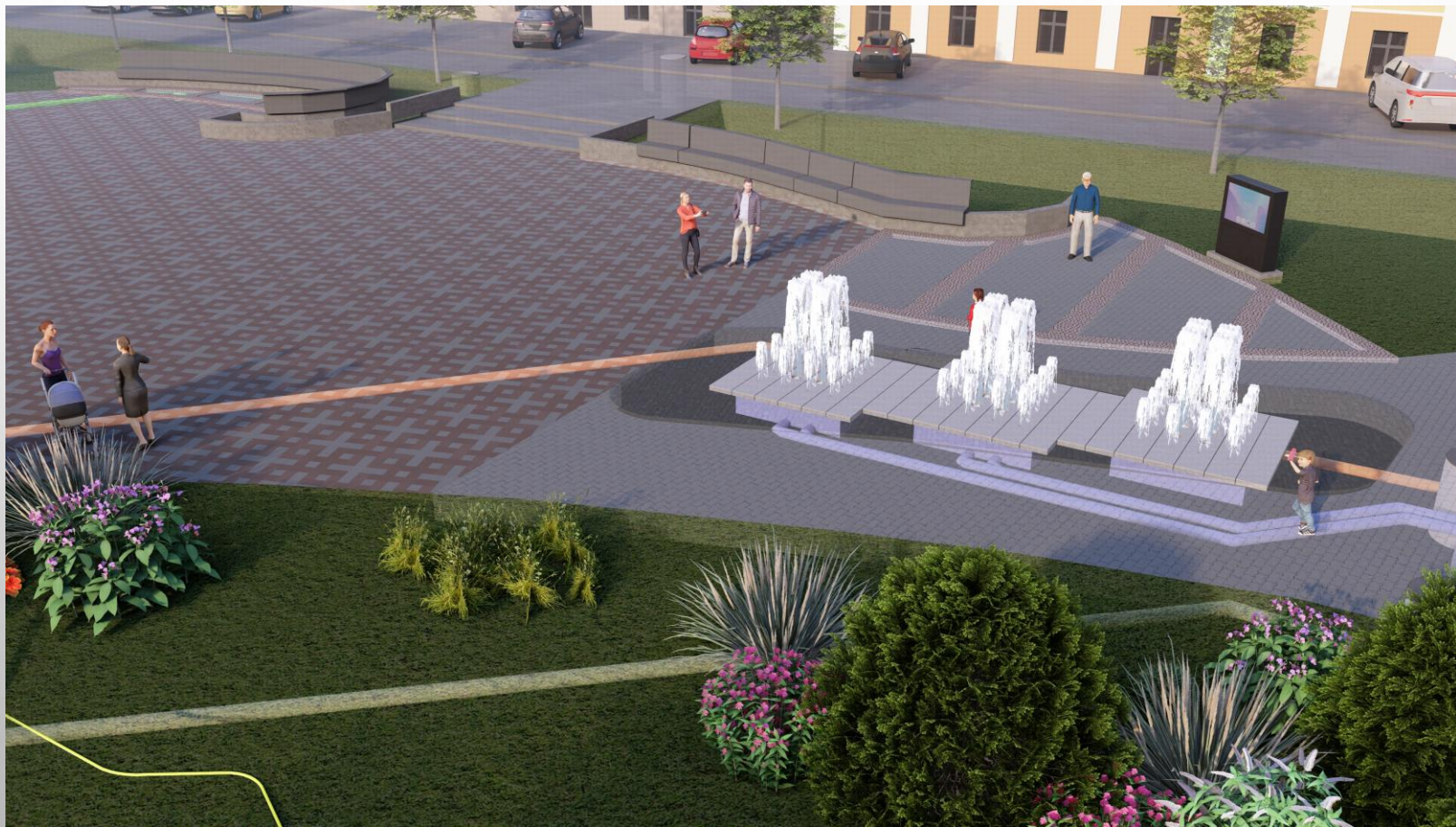

Educated and Informed Society

May 14, 2024

EDUCATIONAL AND INFORMATIONAL ACTIVITIES IN SALDUS

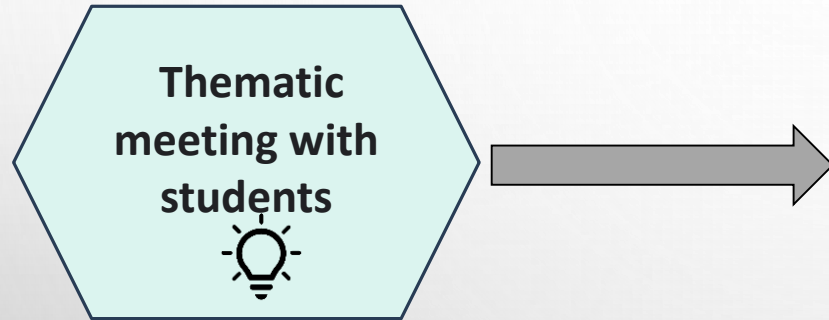

Topics Covered: *Climate change, Water reuse practices, Planned activities within the project*

Saldus Elementary School participants: 93
Saldus Secondary School participants : 84

Two of the largest schools in Saldus:



Educated and Informed Society

September 27, 2024

EDUCATIONAL AND INFORMATIONAL ACTIVITIES IN SALDUS

Thematic meeting
with Saldus
residents

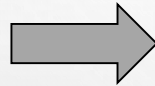

Informative event about
four projects
implemented in Saldus
Municipality. One of them
is WaterMan.



**KAS NOTIEK?
SALDUS NOVADĀ**

4 SVARĪGI PROJEKTI
4 IESPĒJAS UZZINĀT

27. SEPTEMBRĪ
KALPAKA LAUKUMĀ, SALDŪ
NO 16.30 LĪDZ 19.00

SLIKTU LAIKAPSTĀKLU CADŪJUMA
PASĀKUMS SALDUS KOPĒLĪBĀ,
Striķu ielā 2, 2. stāvā

NĀC UN UZZINI!

ORGANIZĒ:
SALDUS NOVADA PASVALDĪBAS
ATTĪSTĪBAS NODALA

IKOPtelpa

SVĒDZĒJOT DARĒŠMĀS:
UZ PĀGALMAI IERĀDĪTES
KĀJĀM VAI AR VĒLOJ:
LĪDZI NĒMĒ SAVU ODIENS
PUDELI
(Saldus pilnvaro centrā ir iespēja
to pasūtīt)

Saldus piepilde

WaterMan

Projekta par
LIETUSŪDENS
ATKĀRTOTU
IZMANTOŠANU

KULTŪRA UN
NOSŪCĪJUMU

Nākotnes
iedzīvotāji

SĀTIŅU DANĪTAVA

Jaundab
Kārtība

Local press representatives were invited

Future Plans for Rainwater and Wastewater Management in Saldus Municipality



- Implement the developed innovative project idea, attracting investments.
- Collaboration with entrepreneurs in realizing new, innovative ideas in Saldus - reuse treated wastewater for business needs.

Vision

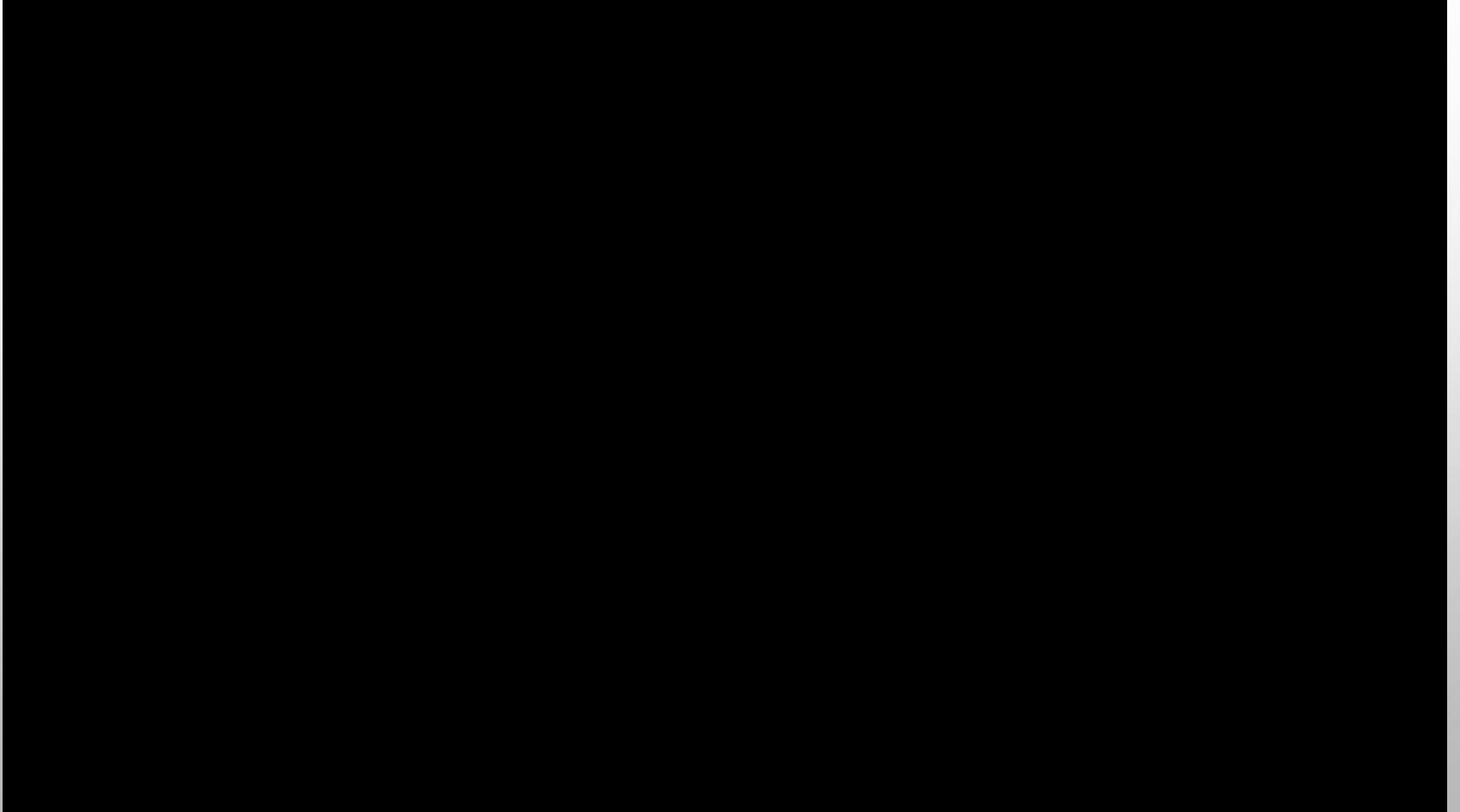



Jānis Blūms



+371 29551442



111water@inbox.lv

Eva Jēkobsone



+371 20267729



eva.jekobsone@saldus.lv